

AC Performance Plus (Carbon Blue) MT ASSEMBLY INSTRUCTIONS

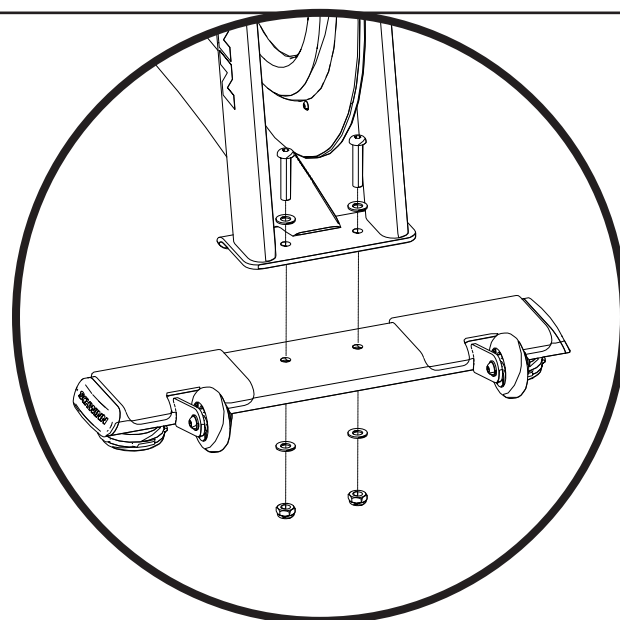

STEP 1: Install the front stabilizer using a 5mm allen key and a 17mm open-ended wrench to secure two (2) pieces each of the M10 x 50mm screws and M10 nuts. Be sure to place one (1) piece of the M10 washer between the nuts and the stabilizer as well as the screws and the frame. **Repeat this step to attach the rear stabilizer to the frame.**

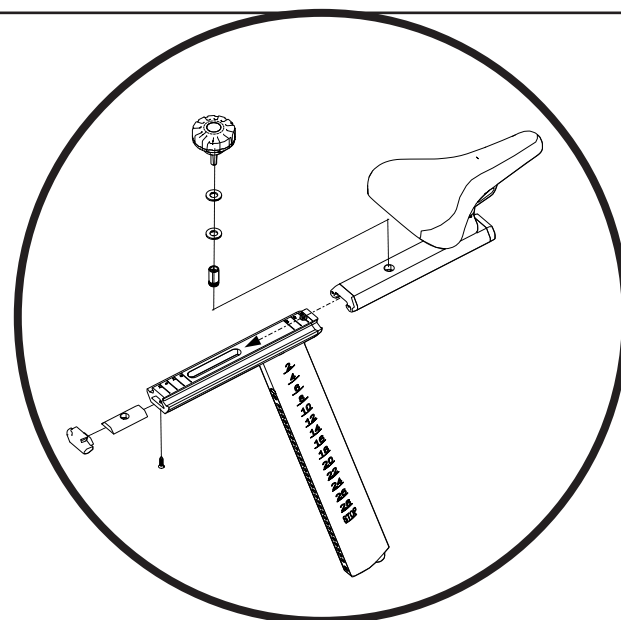

STEP 2: Insert one (1) piece of the trapezoidal fore/aft locking nut into the seat post slider then slide the fore/aft seat slider onto the seat post. Insert one (1) piece of the threaded collar locking nut through the hole in the fore/aft seat slider and into the trapezoidal fore/aft locking nut then tighten with a 10mm allen key. Next, slide one (1) piece each of the M8 washer and M8 nylon washer onto the fore/aft adjustment knob then tighten the fore/aft adjustment knob into the threaded collar locking nut. Finally, insert the end cap into the seat post and secure using a phillips screwdriver and one (1) piece of M4 x 19mm screw.

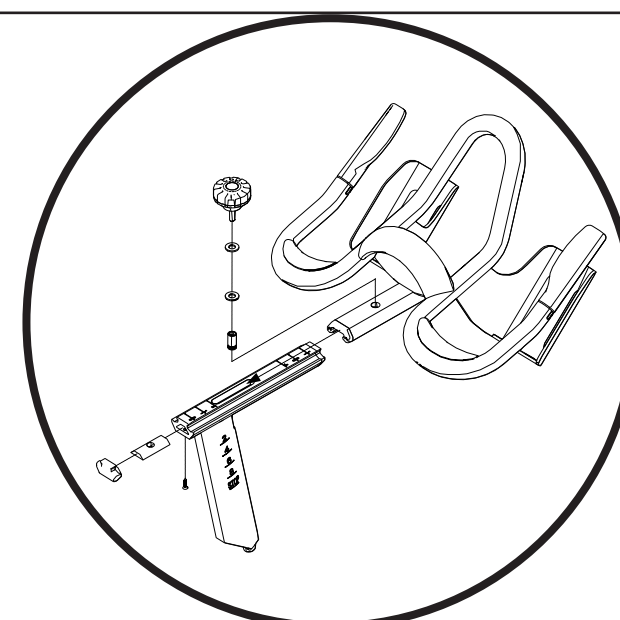

STEP 3: Insert one (1) piece of the trapezoidal fore/aft locking nut into the handlebar post slider then slide the fore/aft handlebar slider onto the handlebar post. Insert one (1) piece of the threaded collar locking nut through the hole in the fore/aft handlebar slider and into the trapezoidal fore/aft locking nut then tighten with a 10mm allen key. Next, slide one (1) piece each of the M8 washer and M8 nylon washer onto the fore/aft adjustment knob then tighten the fore/aft adjustment knob into the threaded collar locking nut. Finally, insert the end cap into the handlebar post and secure using a phillips screwdriver and one (1) piece of M4 x 19mm screw.

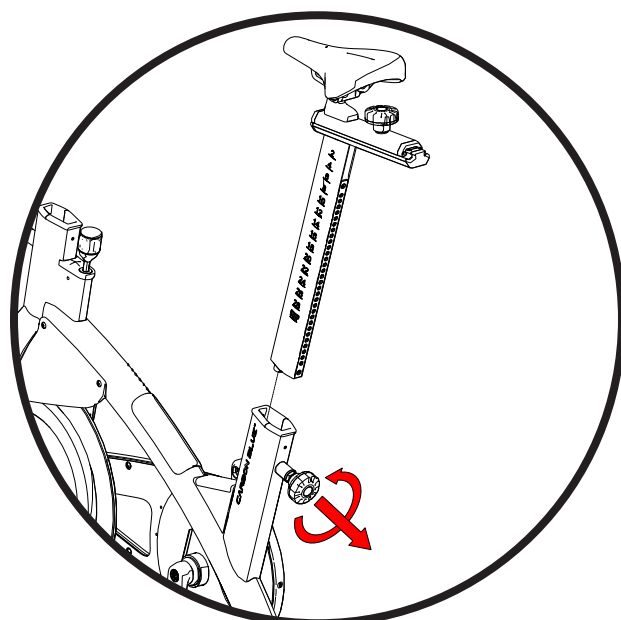

STEP 4: Slide the seat post assembly built in Step 2 into the frame by loosening the height adjustment pop pin, then pulling outwards on the pin while sliding the seat post assembly into the frame.

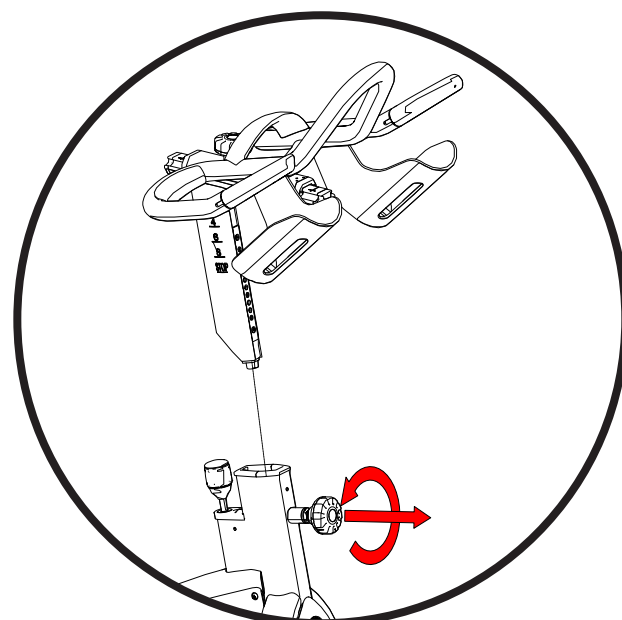

STEP 5: Slide the handlebar post assembly built in Step 3 into the frame by loosening the height adjustment pop pin, then pulling outwards on the pin while sliding the handlebar post assembly into the frame.

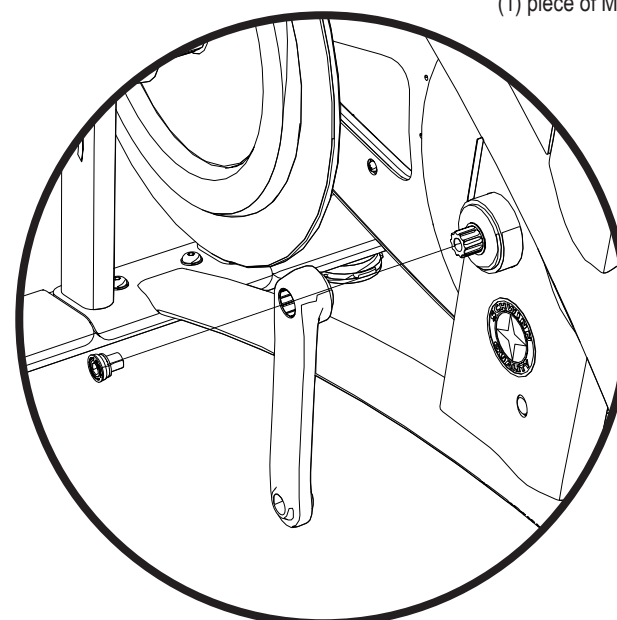

STEP 6: IF 4III POWER SENSOR IS BEING INSTALLED, SKIP THIS STEP AND REFER TO INSTALL DOCUMENTATION FOR THE 4III CRANK ARM. Install the left crank arm onto the left side of the bottom bracket ensuring that the right crank arm is at the 12 o'clock position while the left crank arm is at the 6 o'clock position. Finally, use a torque wrench and a 8mm allen key socket to secure one (1) piece of the crank bolt through the crank arm and into the bottom bracket, torquing to 33-37 ft-lbs (48 Nm)

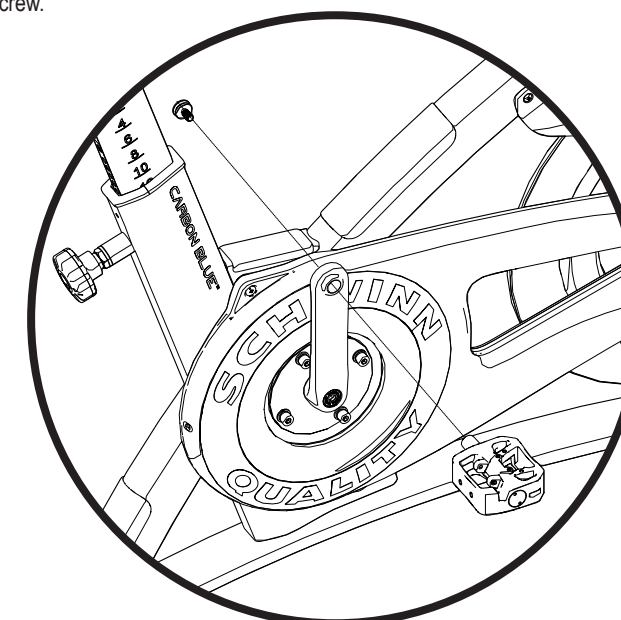

STEP 7: Insert the right pedal into the rider right side crank arm and tap firmly with a rubber mallet. Finally, use a torque wrench and a 8mm allen key socket to secure one (1) piece of the crank bolt from the other side of the pedal, torquing to 33-37 ft-lbs (48 Nm). **Repeat this step for the rider left side pedal.**